

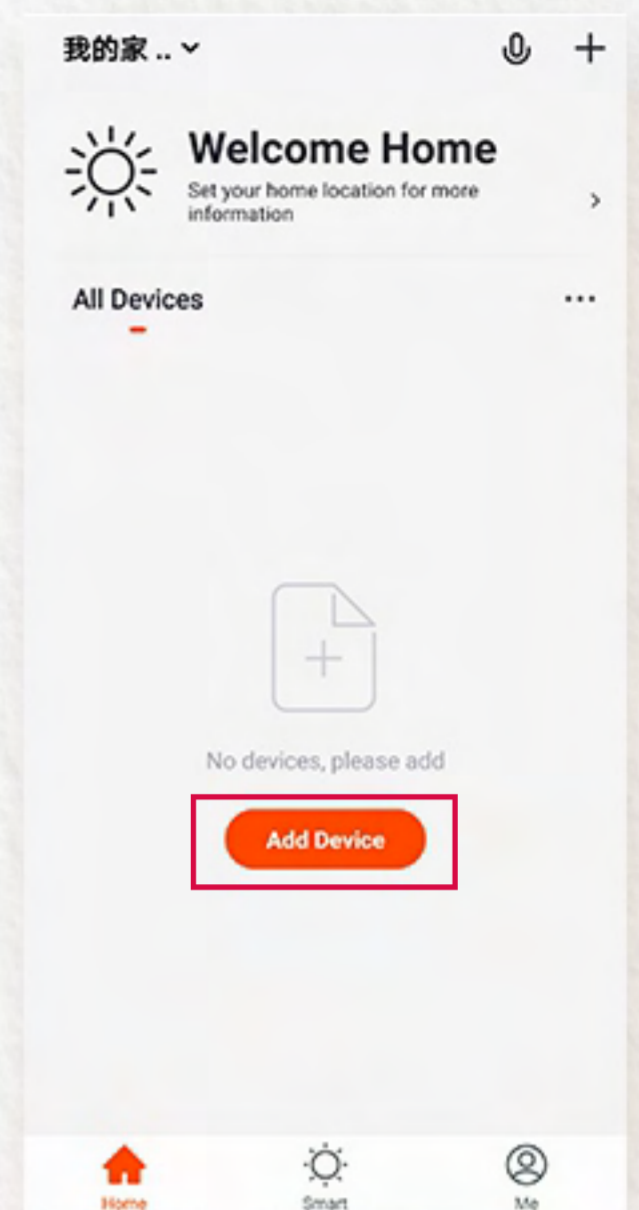

Tuya Inc. search

Download TUYA APP, click on "Add Device", turn on and turn off the ceiling light 5 times, till the light flickering, then it matches.

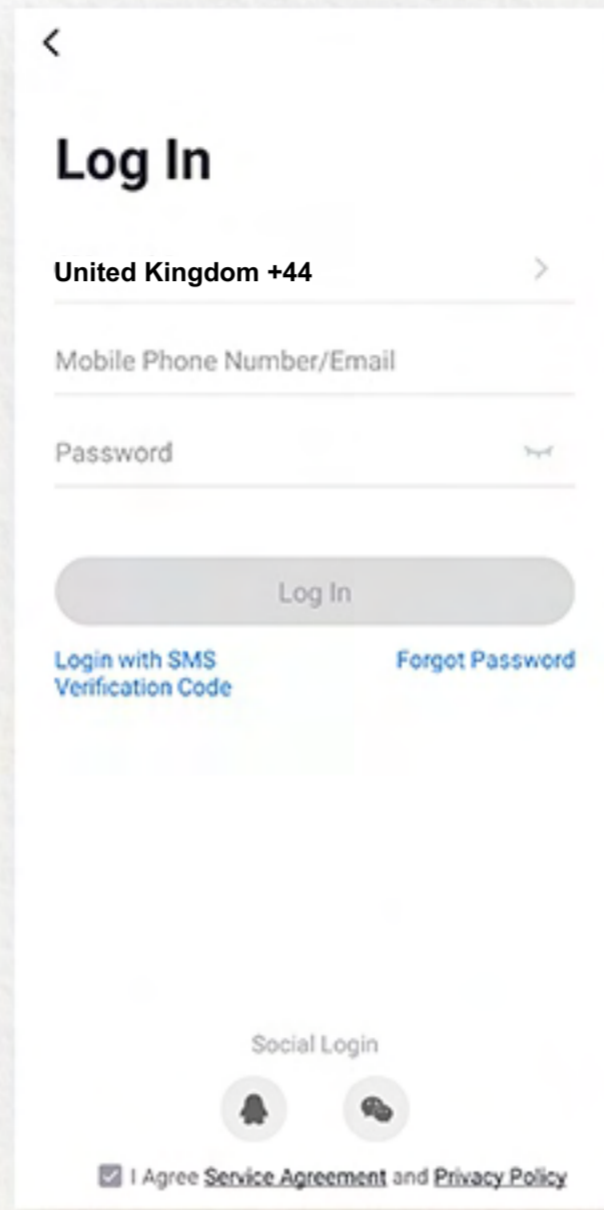
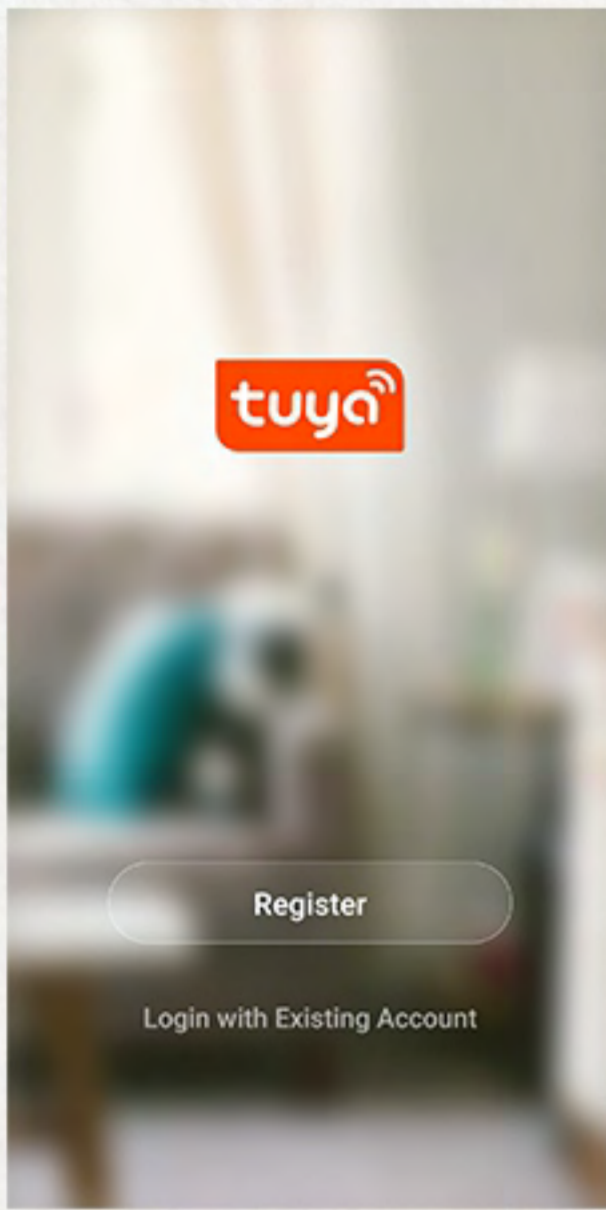

Enter into "Lighting option" and add Lighting(Bluetooth) device, search for the light fixture and make them matched by bluetooth.

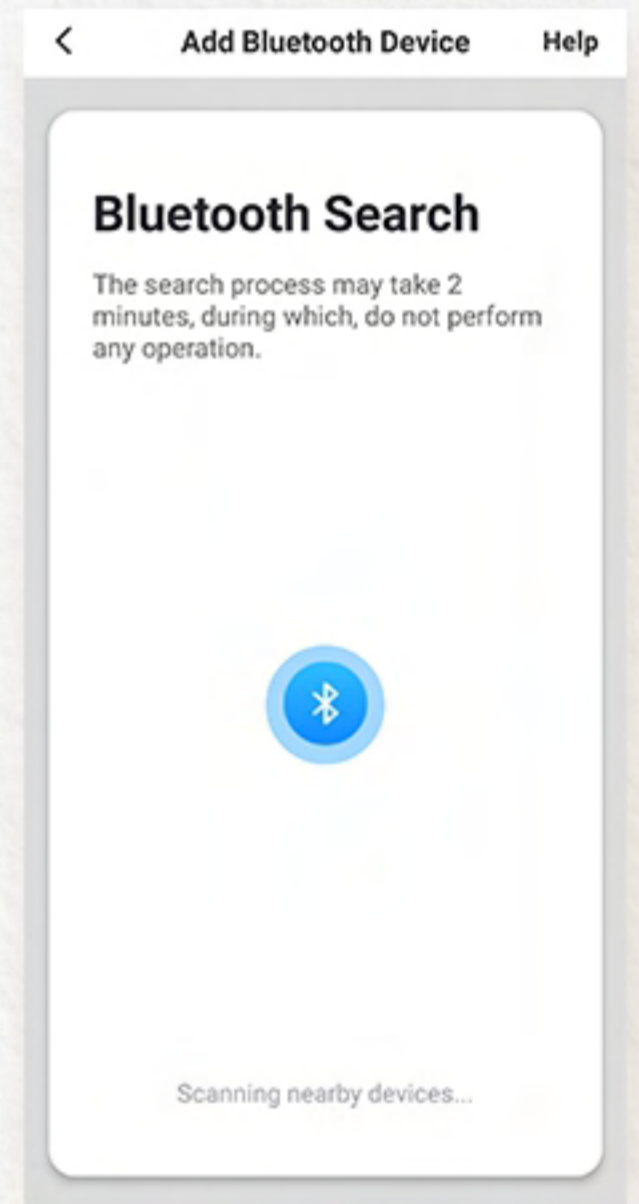
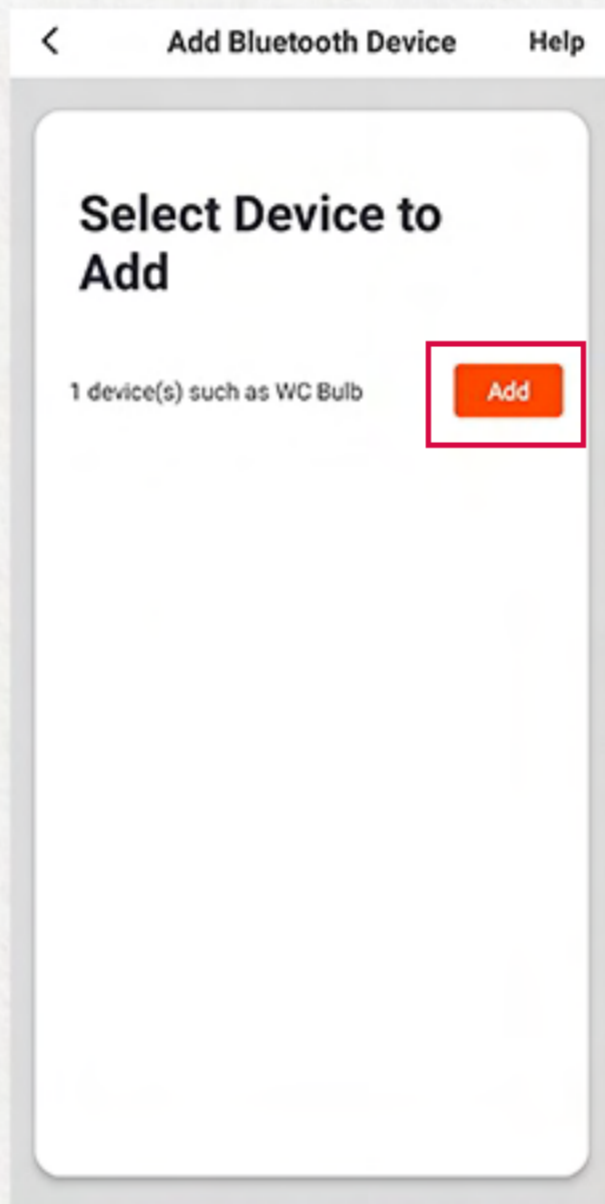
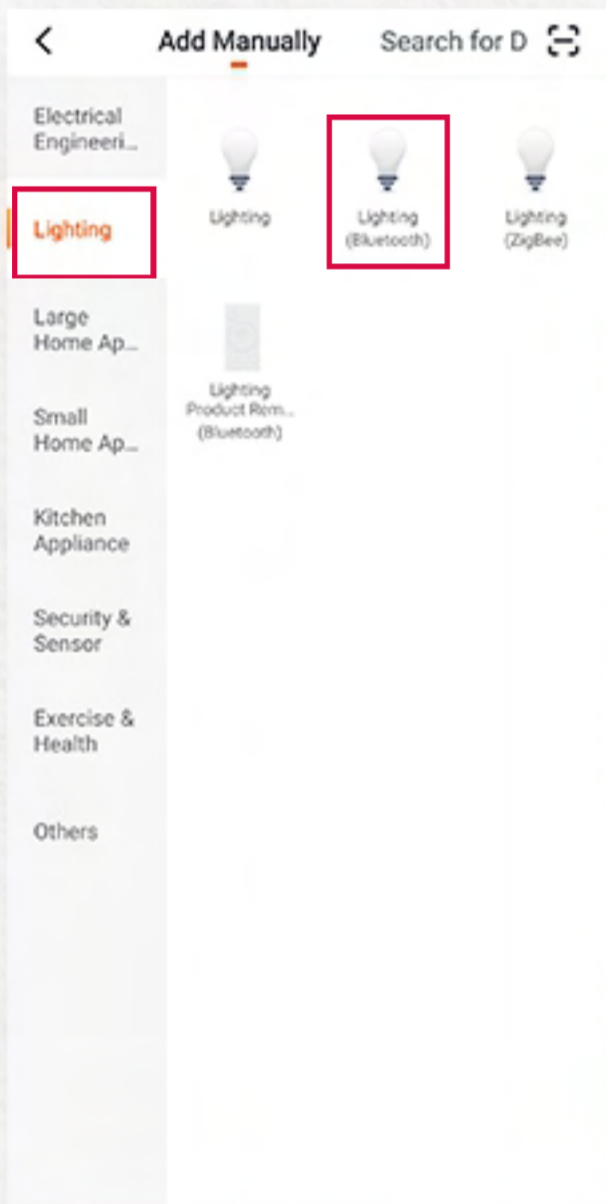

After Bluetooth connected done, click the light fixture and enter into control panel to dim and change CCT of the ceiling lamp.

